

GROUND FLOOR RETAIL SPACE

601-603 MISSION ST
SAN FRANCISCO

**Excellent
Signage
Opportunity!**



**Signage
at corner**

LOCATION

601-603 Mission Street, at Mission and 2nd Streets in downtown San Francisco.

PROPERTY DESCRIPTION

This excellent retail space is located in the center of the South Financial District with four new high rises within a 1 block radius. Mission Street is one of the highest travelled corridors in downtown SF, the perfect location between the Financial District and SOMA. This space has great visibility and optimum storefronts. 603 Mission St was previously vented for a restaurant.

TENANTS WITHIN 2 BLOCKS

- | | |
|------------------|-----------------|
| Anchor & Hope | 111 Minna Bar |
| Peets | Starbucks |
| Roy's Restaurant | Katz's Bagels |
| Umbria | The Art Academy |

2008 DEMOGRAPHICS

Radius	0.25 mi	0.05 mi	1.0 mi
Daytime Pop	44,433	141,596	239,983
Businesses	3,283	10,899	19,597

SPACE AVAILABLE

Ground floor, retail space (can be combined)

603 Mission St **2,172 sf**

601 Mission St **5,300 sf**

(includes mezzanine)

1,500 sf of basement space also available

For more information, please contact:

METROVATION
BROKERAGE

Kurt Grundman
kurt@metrovation.com
(415) 640-8779

CA DRE License # 01388960

www.metrovationbrokerage.com

MAP

601-603 Mission Street
San Francisco, CA

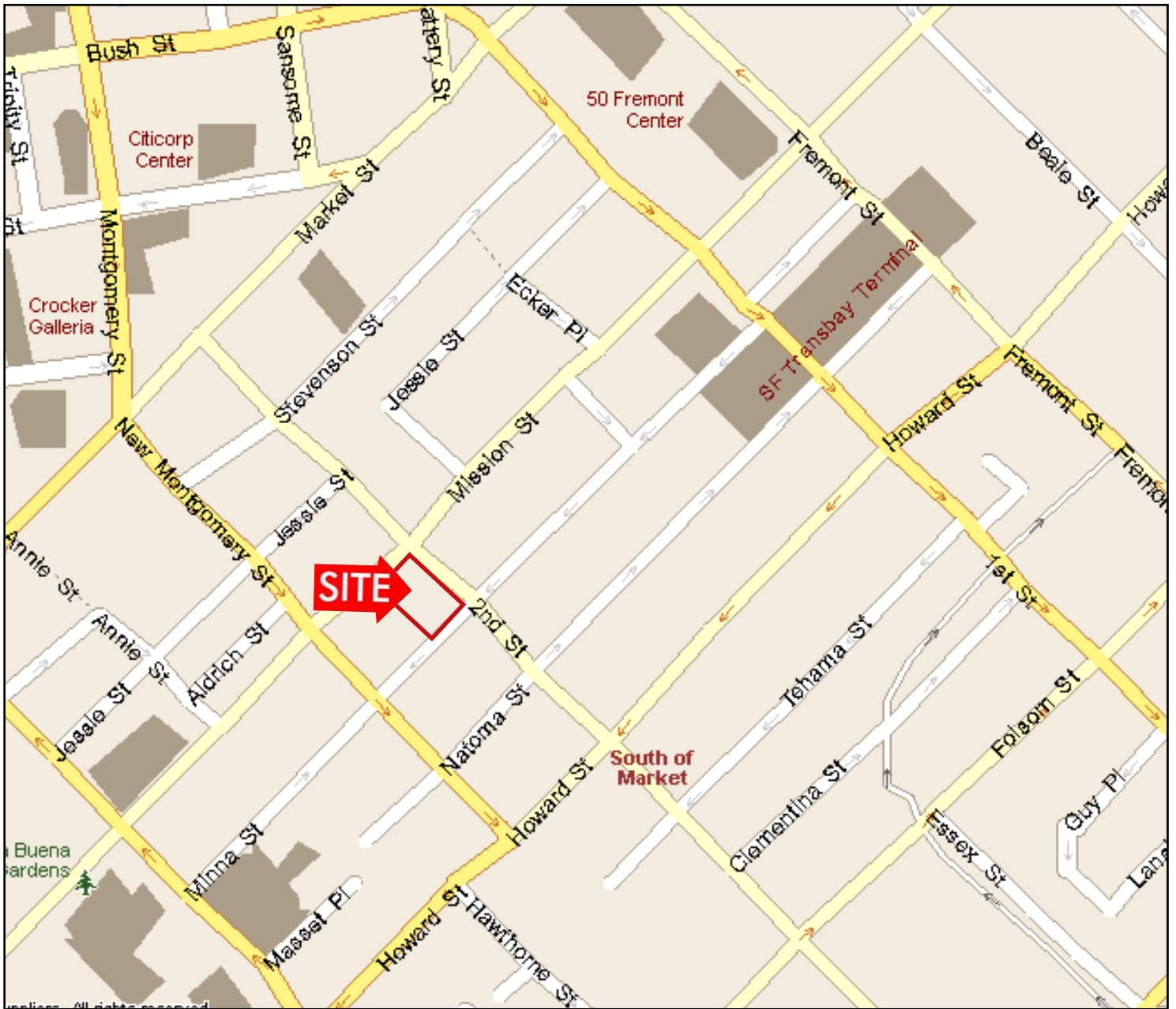

FLOOR PLAN: Ground Floor

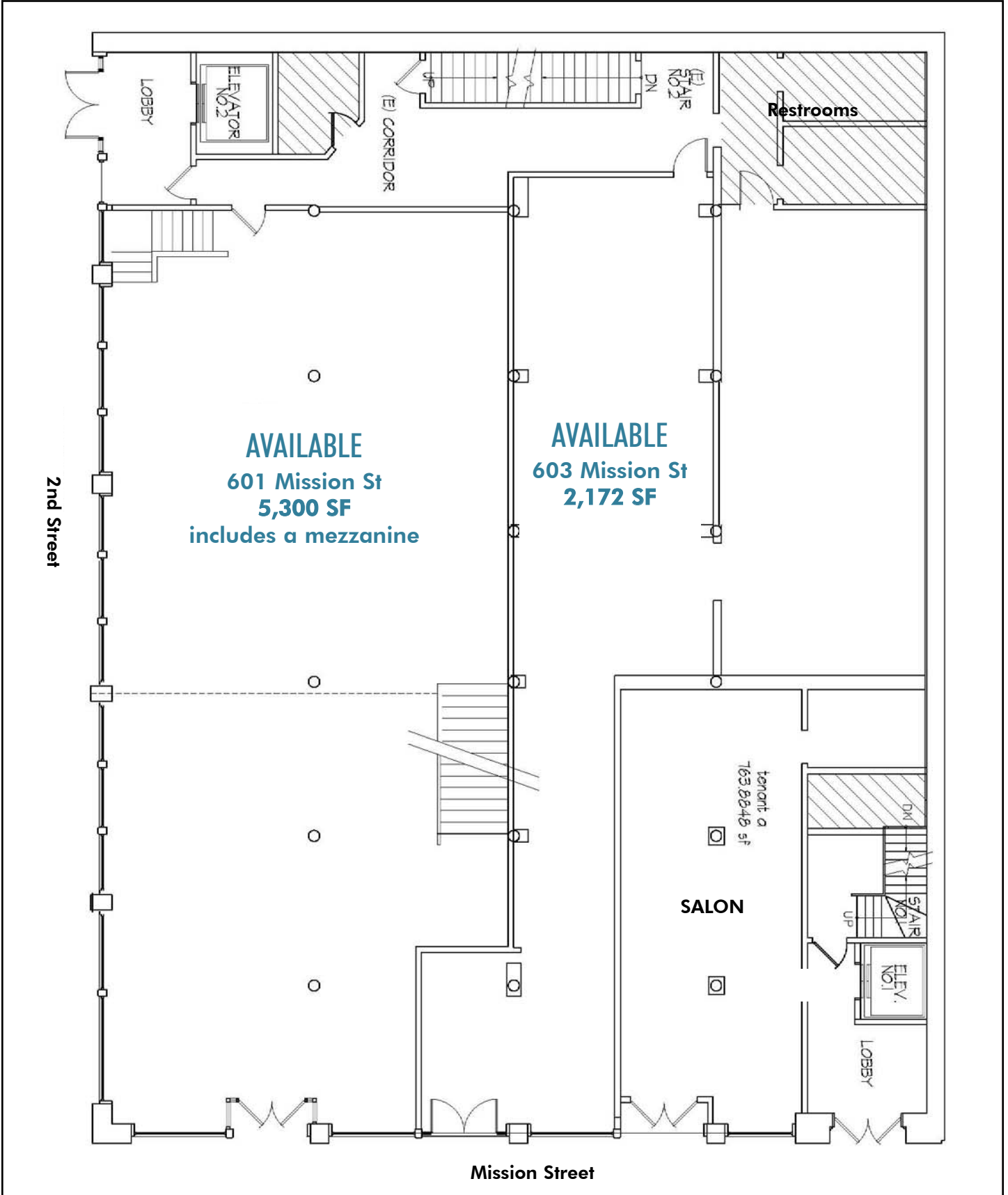

FLOOR PLAN: Mezzanine Level

