

HIGH IMPACT CORNER SPACE

Jack London Square Area, 550 Second St, Oakland



LOCATION

This terrific corner retail location, at 2nd Street and Clay Street, in the heart of the Oakland Ironworks District, is located at the northeast corner of Jack London Square.

PROPERTY HIGHLIGHTS

This space has excellent visibility and a large glass storefront. Located in a growing retail shopping district, with tenants such as Bed, Bath & Beyond, Cost Plus World Market, Beverages & More!, Ace Hardware, Swarm Art Gallery, the Oakland Metro Opera, Yoshi's, and the Jack London Cinema. This location is also steps away from the restaurants and entertainment options in Jack London Square, as well as almost 1,500 residential units in the immediate area.

20 ft high ceilings give lots of great build-out options, and venting for a restaurant is possible. Easy freeway, BART and Ferry access. Plentiful parking.

2012 DEMOGRAPHICS

miles	1 mi	3 mi	5 mi
Population	25,542	209,458	436,394
Avg. HH Inc.	\$40,811	\$53,380	\$64,103
Daytime Pop	54,639	135,284	217,979

SPACE AVAILABLE

2,610 sf

For more information,
please contact exclusive leasing agent:

METROVATION
BROKERAGE

Linda Braz

lbraz@metrovation.com

CA DRE License # 01198147

METROVATION BROKERAGE
(510) 839-4000 x 232

AREA MAP

550 Second Street

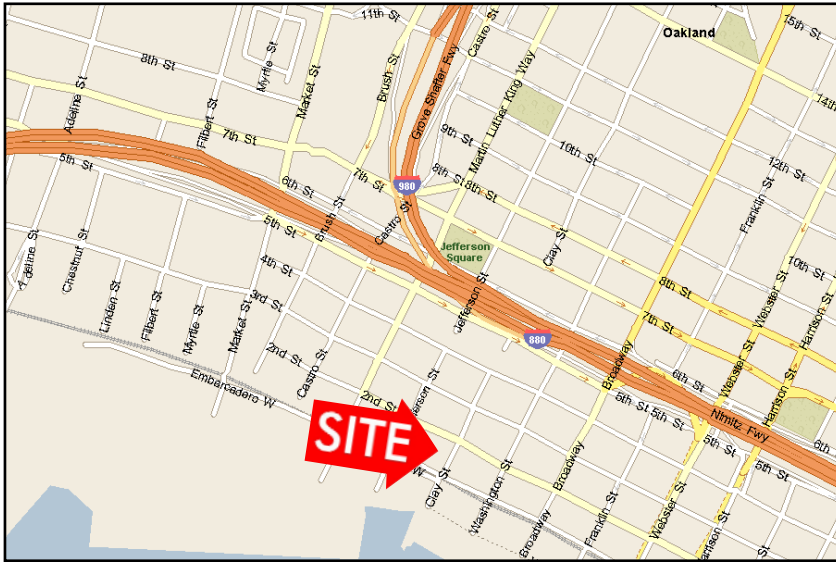

IRONWORKS DISTRICT Oakland



FLOOR PLAN

550 Second Street

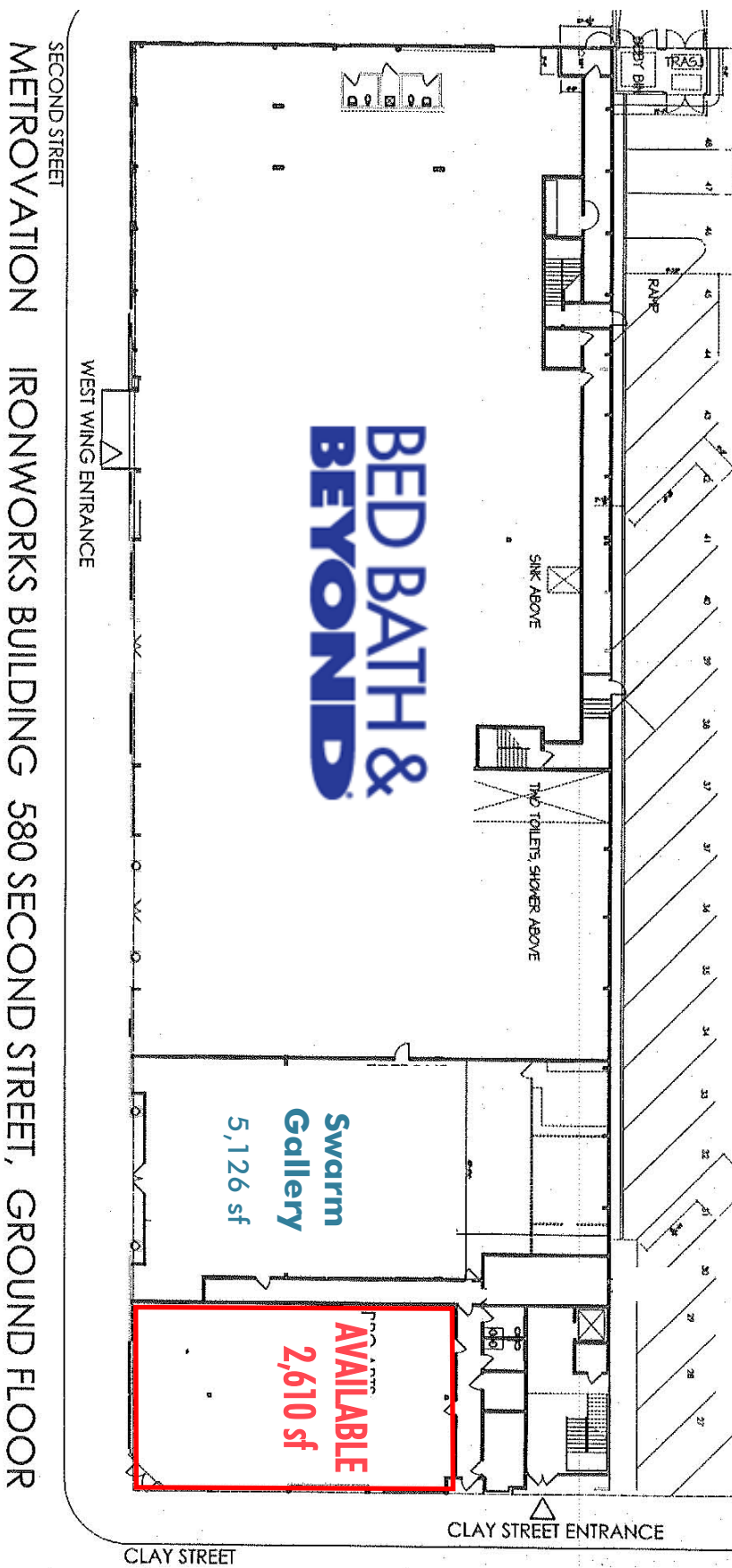

SECOND STREET
METROVATION
IRONWORKS BUILDING
580 SECOND STREET, GROUND FLOOR

CLAY STREET